

Concord-Lake Sunapee Rail Trail (CLSRT) Exit 9 Project: History on a highway map We started with a river.

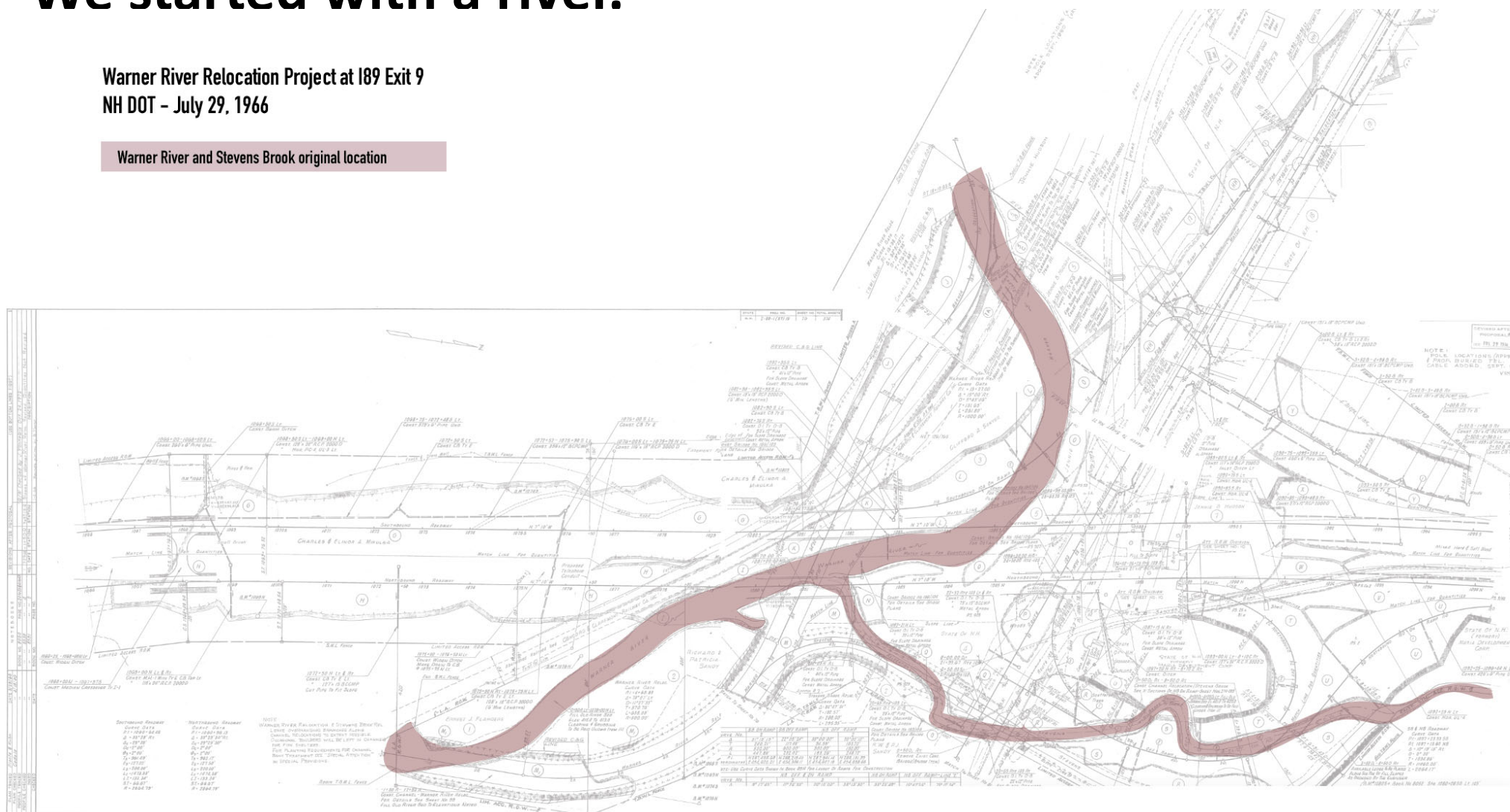

Warner River Relocation Project at I89 Exit 9
NH DOT - July 29, 1966

Warner River and Stevens Brook original location



Concord-Lake Sunapee Rail Trail (CLSRT)

Exit 9 Project: History on a highway map

We added roads in the 1700's



Warner River Relocation Project at I89 Exit 9
NH DOT - July 29, 1966

Warner River and Stevens Brook original location

Local roads / Waterloo

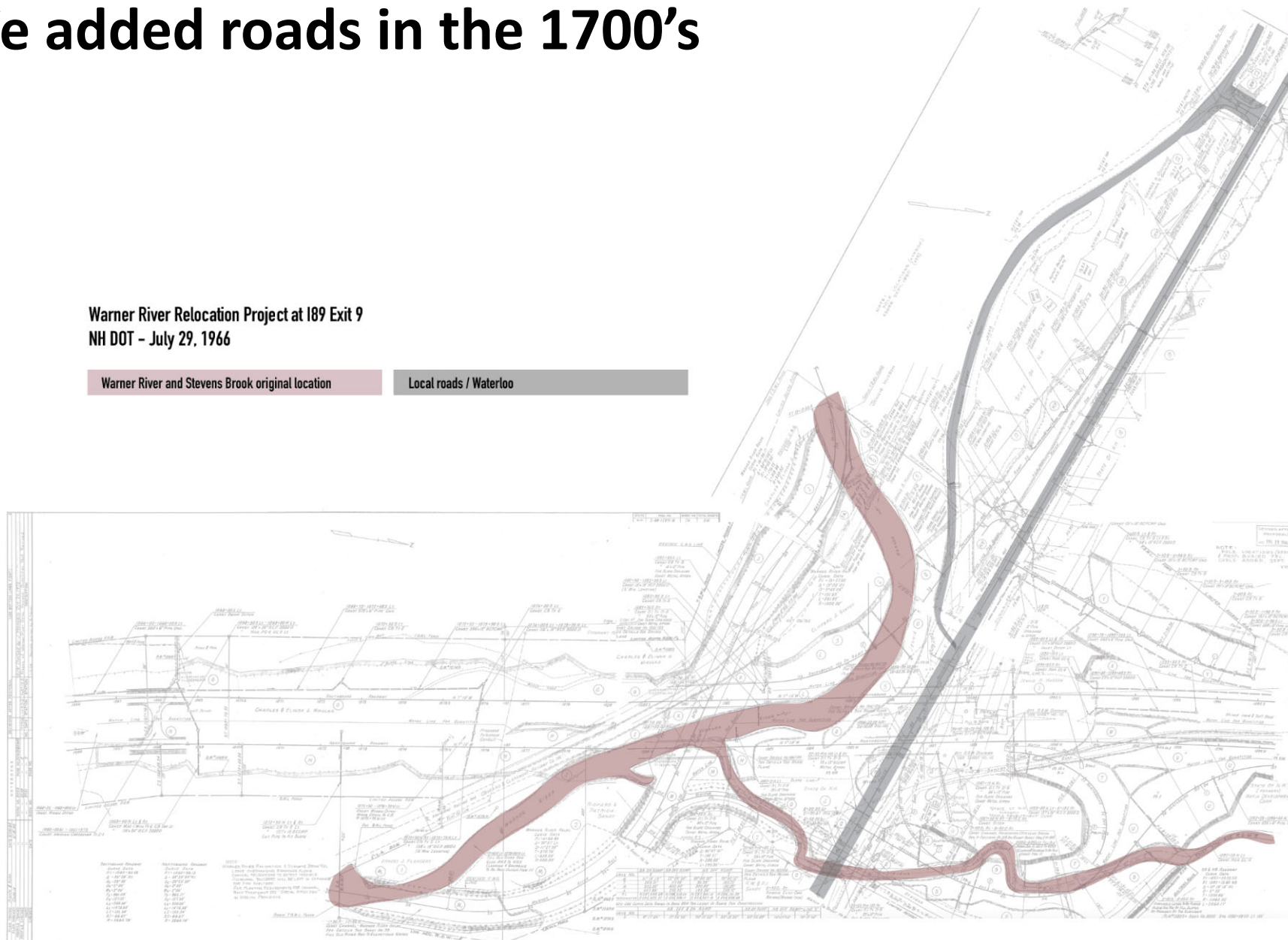

Concord-Lake Sunapee Rail Trail (CLSRT)

Exit 9 Project: History on a highway map

We added the railroad in the 1800's

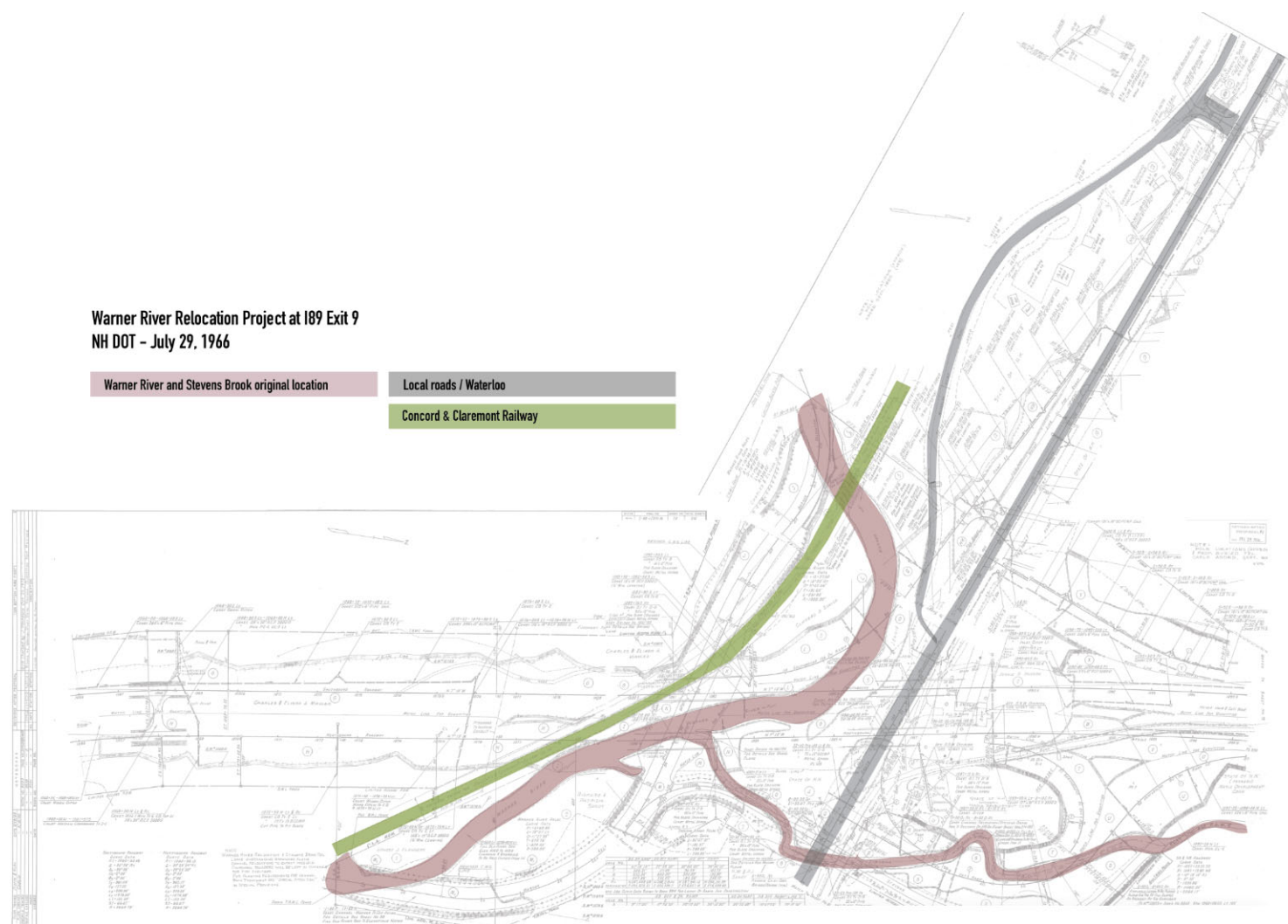

Concord-Lake Sunapee Rail Trail (CLSRT) Exit 9 Project: History on a highway map To add the interstate they did this...



Warner River Relocation Project at I89 Exit 9
NH DOT - July 29, 1966

Warner River and Stevens Brook original location	Interstate 89 / NH State Route 103
Warner River and Stevens Brook after relocation project	Concord & Claremont Railway

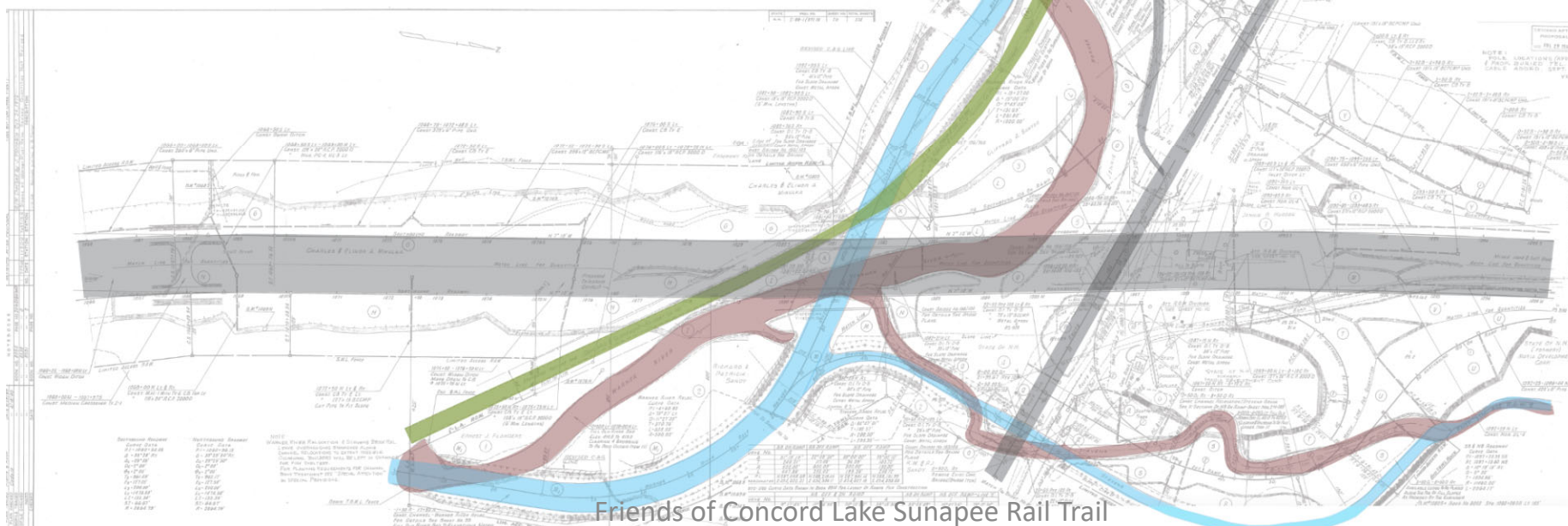

Concord-Lake Sunapee Rail Trail (CLSRT)

Exit 9 Project: History on a highway map

So today we you see this.



Warner River Relocation Project at I89 Exit 9
NH DOT - July 29, 1966

Warner River and Stevens Brook original location	Interstate 89 / NH State Route 103
Warner River and Stevens Brook after relocation project	Concord & Claremont Railway
Warner River and Stevens Brook after relocation project	Concord Lake Sunapee Rail Trail - Proposed route



Friends of Concord Lake Sunapee Rail Trail

Concord-Lake Sunapee Rail Trail (CLSRT)

Exit 9 Project: History on a highway map

And we are proposing this rail trail.



Warner River Relocation Project at I89 Exit 9
NH DOT - July 29, 1966

Warner River and Stevens Brook original location	Interstate 89 / NH State Route 103
Warner River and Stevens Brook after relocation project	Concord & Claremont Railway
	Concord Lake Sunapee Rail Trail - Proposed route

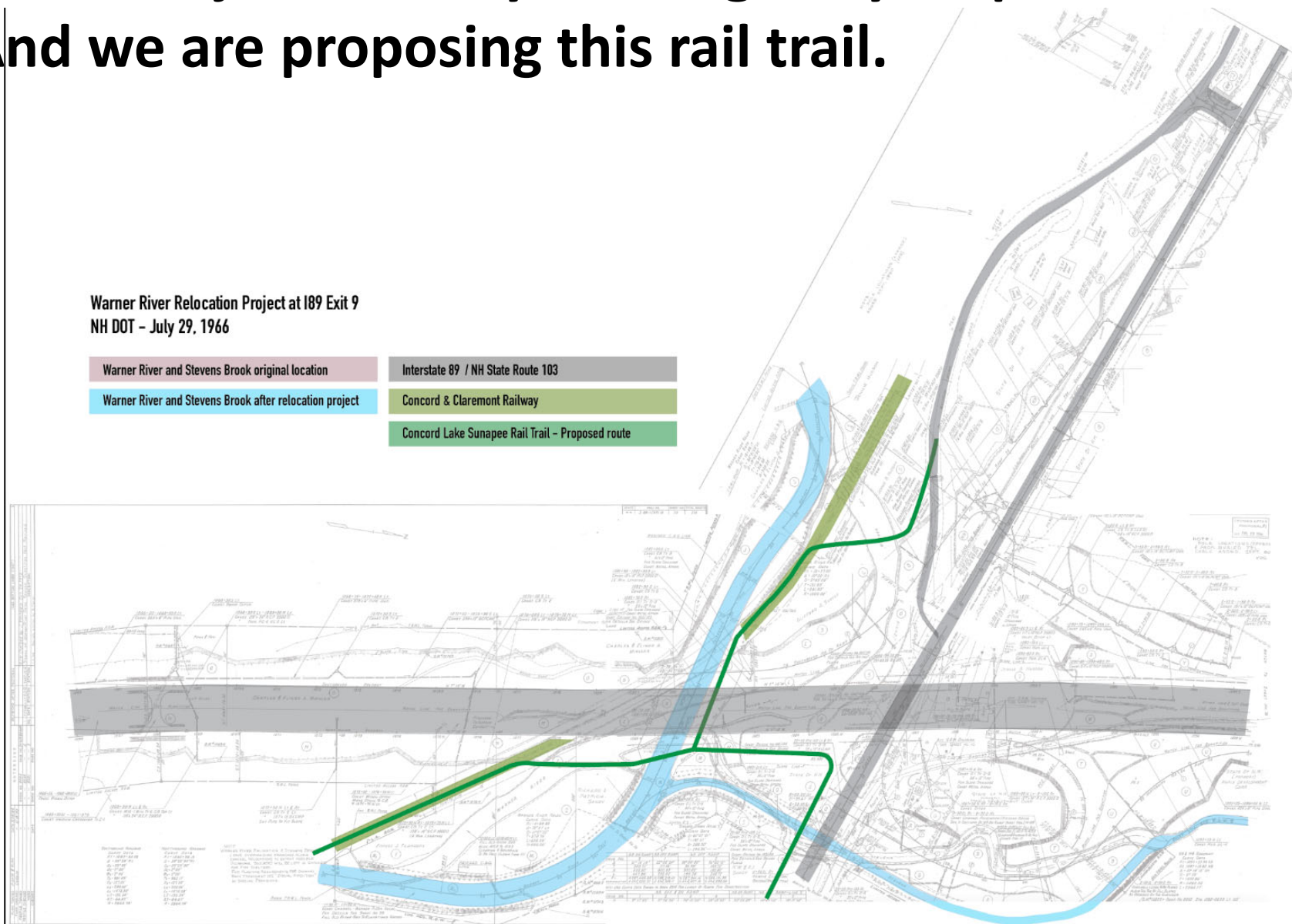

Concord-Lake Sunapee Rail Trail (CLSRT)



Warner River Relocation Project at I89 Exit 9
NH DOT - July 29, 1966

Warner River and Stevens Brook original location	Interstate 89 / NH State Route 103
Warner River and Stevens Brook after relocation project	Concord & Claremont Railway
	Concord Lake Sunapee Rail Trail - Proposed route

